

GPS DATA SHEET

Station Data

Station Name: COSM 08-16		Municipality: City of Salem	
Zone: Virginia South-4502	Convergence: -0° 55' 30"	Year Set: 2008	
Projection: Lambert	Combined Factor: 0.99989791	Year Recovered: 2008	
Horizontal Data	Datum: NAD 83	Scale Factor: 0.999946070	Order: 2nd
	Northing: 3638813.250		Easting: 11039715.387
	Latitude: 37° 18' 24.22298"N		Longitude: 80° 01' 26.16632"W
Vertical Data	Elevation Factor: 0.999951837	Order: 3rd	
	Elevation: (NGVD 29) 1112.89	Elevation: (NAVD 88) 1112.27	

Reference Station

Station	Grid Distance	Grid Azimuth
COSM 08-17	1336.33'	233° 37' 32"

Station Location & Description

The station is located in the north side of the City of Salem, Virginia. To reach from the Roanoke County Courthouse at the intersection of Main Street and Thompson Memorial Drive, go east on Main Street to the intersection with Electric Road (419). Go north on Electric Road to the intersection with Green Ridge Road. Go East on Green Ridge Road to merging intersection with Dalewood Avenue. The station is a brass disk, set in a concrete sidewalk, in front of #1718 Green Ridge Road and is stamped COSM 08-16.

This survey data prepared using 1 meter= 3.2808333333 feet.

Station Sketch

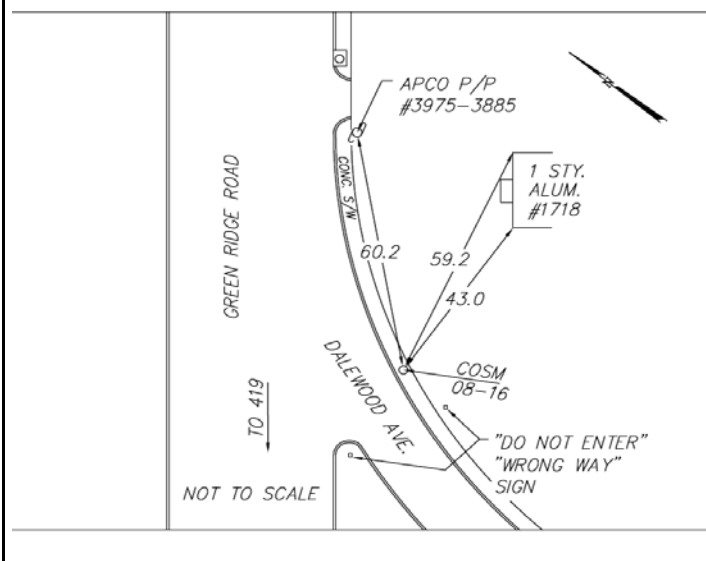

Station Photograph



CALDWELL WHITE ASSOCIATES
ENGINEERS / SURVEYORS / PLANNERS

4203 Melrose Avenue, NW
P.O. Box 6260
Roanoke, VA 24017

Phone: (540) 366-3400
Fax: (540) 366-8702
E-Mail: cwaroanoke@aol.com